

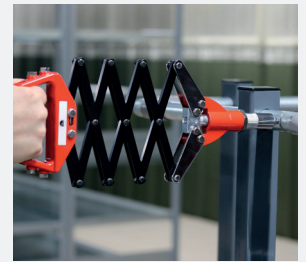

BLIND RIVETS

Quick and easy to use fasteners designed for thin sheet and hard plastic applications. Ideal for applications where welding or bolting is not possible.

During installation the head tightly grips to the back of the work piece whilst giving a low profile and aesthetic finish. Available in A2 304 stainless steel and aluminium for corrosion resistance.



DOME HEAD RIVETS (DIN7337)



CORROSION RATING

1	2	3	4	5
ALUMINIUM				

- Ideal for multiple applications inc. sheet steel to structural steel.
- Aluminium body for an enhanced resistance to corrosion.

Product Code	Size (mm)	Min. grip range (mm)	Max. grip range (mm)	Box Qty (pcs)	Carton Qty (Boxes)
748456	3.2 x 6	1.5	3.5	500	20
748741	3.2 x 8	3.5	5.5	500	20
748852	3.2 x 10	5.5	7.5	500	20
748963	4.0 x 8	3.0	5.0	500	20
748369	4.0 x 10	5.0	6.5	500	20
748258	4.0 x 12	6.5	8.5	500	20
748147	4.8 x 10	4.5	6.0	500	10
748951	4.8 x 12	6.0	8.0	500	10
748357	4.8 x 14	8.0	10.0	500	10



CORROSION RATING

1	2	3	4	5
A2/AUST.SS				

- Ideal for multiple applications inc. sheet steel to structural steel.
- A2 stainless steel body for ultimate resistance to corrosion.

Product Code	Size (mm)	Box Qty (pcs)	Carton Qty (Boxes)
748023	3.2 x 6	500	20
748613	3.2 x 8	500	20
748100	4.0 x 10	500	20
748531	4.0 x 12	250	20
748868	4.8 x 14	250	20
748305	4.8 x 16	250	20

FLANGE HEAD RIVETS (DIN7337)



CORROSION RATING

1	2	3	4	5
ALUMINIUM				

- Larger surface area than dome head rivets make flange head rivets ideal for joining thin, compressible or brittle materials to structural steel.

Product Code	Size (mm)	Box Qty (pcs)	Carton Qty (Boxes)
748918	4.8 x 12	250	20
748735	4.8 x 16	250	20
748499	4.8 x 20	250	20
748264	4.8 x 25	250	20

INSTALLATION GUIDELINES

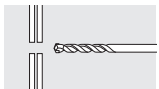

DRILL THE REQUIRED DIAMETER HOLE THROUGH BOTH MATERIALS

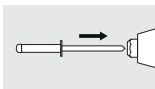

SLIDE THE RIVET TAIL FIRST INTO THE JAWS OF THE RIVETER

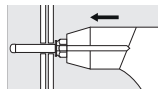

PLACE THE RIVET THROUGH THE HOLE & PRESS THE RIVETER AGAINST IT

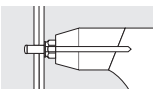

SECURELY SET THE RIVET BY SQUEEZING THE RIVETER HANDLES TOGETHER

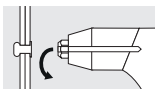

THE RIVETER AUTOMATICALLY SNAPS THE TAIL FROM THE RIVET HEAD. DISCARD THE TAIL AFTERWARDS

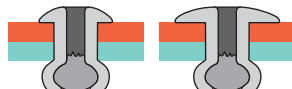

DOME HEAD

FLANGE HEAD

TECHNICAL DATA

	Aluminium		
	3.2	4.0	4.8
Size Ø (mm)	3.2	4.0	4.8
Drill Hole Ø (mm)	3.3	4.1	4.9
Shear Load (N)	670	1050	1700
Shear Load (Kg)*	68.3	107.7	173.3
Tensile (N)	900	1560	2230
Tensile (Kg)*	91.8	159.0	227.4
	Stainless Steel		
	3.2	4.0	4.8
Size Ø (mm)	3.2	4.0	4.8
Drill Hole Ø (mm)	3.3	4.1	4.9
Shear Load (N)	1900	2900	4230
Shear Load (Kg)*	193.7	295.7	431.34
Tensile (N)	2500	3560	5340
Tensile (Kg)*	254.9	363.0	544.5

* These results have been obtained by internal testing. Performance may greatly vary with the type or thickness of materials used. Be sure to allow a safety factor of at least three to one.

INSTALLATION & DIMENSION DATA

Product Code	Head Ø d1 (mm)	Head Length L (mm)	Mandrel Length P (mm)	Head Depth K (mm)	Head Collar Ø d2 (mm)	Min. Grip Range (mm)	Max. Grip Range (mm)
Dome Head DIN7337 - Aluminium							
748456	3.2	6	27	0.8	6.5	1.5	3.5
748741	3.2	8	27			3.5	5.5
748852	3.2	10	27	1.0	8.0	5.5	7.5
748963	4.0	8	27			3.0	5.0
748369	4.0	10	27			5.0	6.5
748258	4.0	12	27	1.1	9.5	6.5	8.5
748147	4.8	10	27			4.5	6.0
748951	4.8	12	27			6.0	8.0
748357	4.8	14	27	8.0	10.0		
Dome Head DIN7337 - A2 Stainless Steel							
748023	3.2	6	27	0.8	6.5	1.0	3.0
748613	3.2	8	27			3.0	5.0
748100	4.0	10	27	1.0	8.0	4.5	6.5
748531	4.0	12	27			6.5	8.5
748868	4.8	14	27			8.0	9.5
748305	4.8	16	27	9.5	11.0		
Flange Head DIN7337 - Aluminium							
748918	4.8	12	27	2.5	14	6.0	8.0
748735	4.8	16	27			10.0	12.0
748499	4.8	20	27			15.0	17.0
748264	4.8	25	27			16.0	21.0

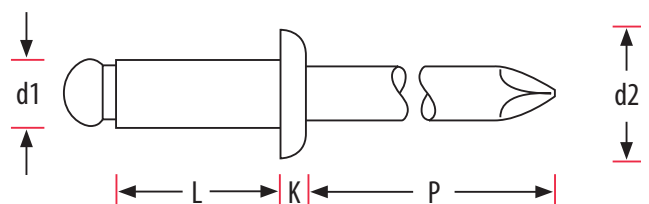

d1	Head Diameter
L	Head Length
K	Head Collar Depth

P	Mandrel Length
d2	Head Collar Diameter